

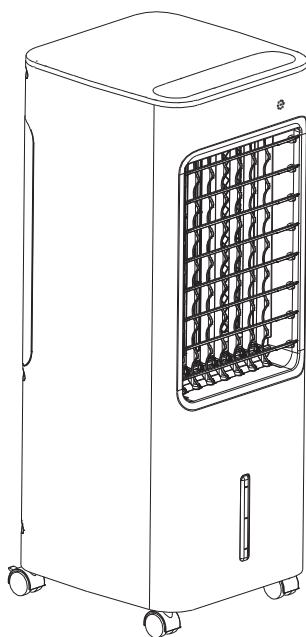

OWNER'S MANUAL

AIR COOLER
AC100-18BR



READ AND SAVE THESE INSTRUCTIONS

Attention: Pictures in the IM are for reference only.

SAFETY INSTRUCTION

1. If the supply cord is damaged, it must be replaced by manufacturer, its service agent or a similarly qualified person in order to avoid a hazard.
2. This appliance can be used by children aged from 8 years and above and persons with reduced physical, sensory or mental capabilities or lack of experience and knowledge if they have been given supervision or instruction concerning use of the appliance in a safe way and understand the hazards involved. Children shall not play with the appliance. Cleaning and user maintenance shall not be made by children without supervision.
3. Unplug the appliance during filling and cleaning.
4. Prior to cleaning or other maintenance, the appliance must be disconnected from the supply mains.



5.  Correct Disposal of this product

This marking indicates that this product should not be disposed with other household wastes throughout the EU. To prevent possible harm to the environment or human health from uncontrolled waste disposal, recycle it responsibly to promote the sustainable reuse of material resources. To return your used device, please use the return and collection systems or contact the retailer where the product was purchased. They can take this product for environmental safe recycling.

INSTALLATION INSTRUCTIONS

■ Name of components

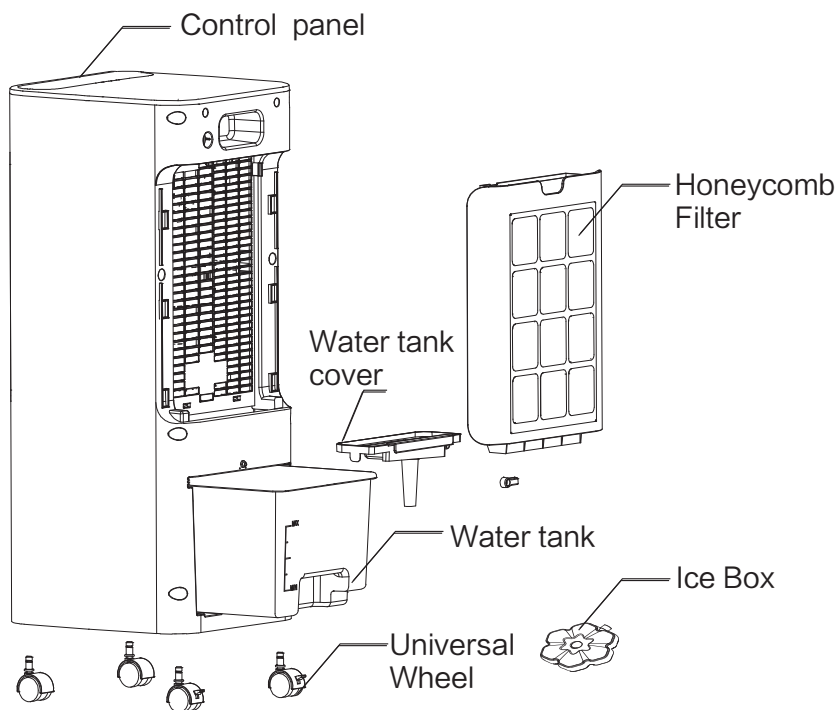

Foot-Wheel Installation

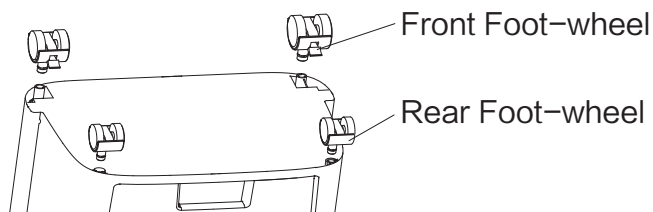

■ Instructions for operation of body

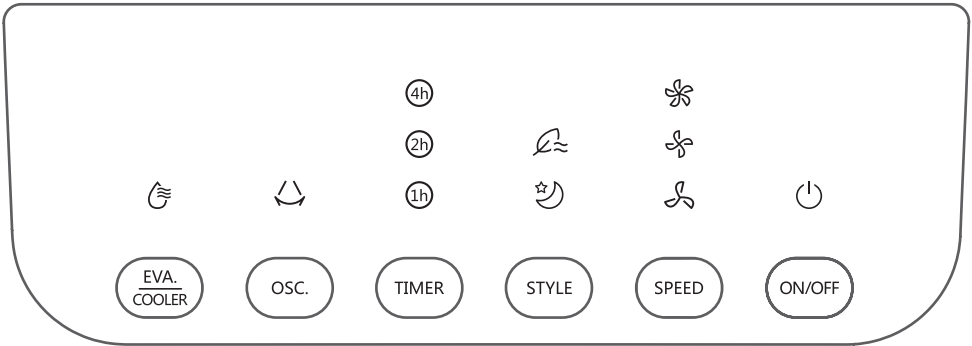

Press a key on the unit to activate a corresponding function.

For instance:

- Press [SPEED] Key to adjust 3 speeds of air flow.
- Press [STYLE] Key to switch between Natural and Sleep Functions.
- Press [TIMER] Key: When the fan is on, press the “PRO./TIMER” key to time the fan to shut down after 1–7 hours. In stand-by mode, you can pre-set the fan to start in 1–7 hours.
- When [^{EVA.}COOLER] Key is pressed, the indicator lights up constantly if the operation is normal; when the indicator flashes, it denotes a water shortage, please add water immediately.

Considerate Hint:

Push Buttons on the unit may differ based on the actual product model.

■ Using the Water tank

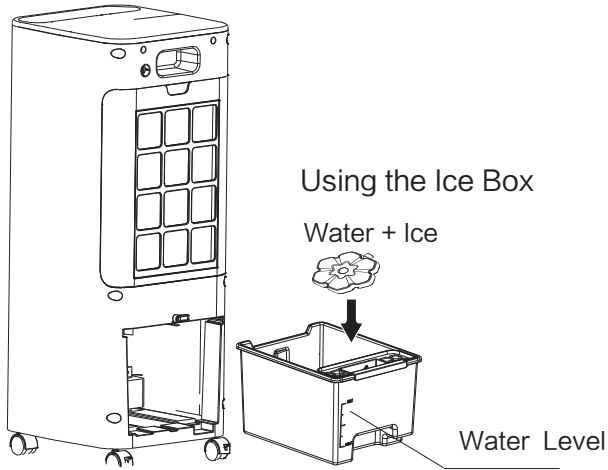

Considerate Hint:

When humidifying, water level in the Water Tank must remain under MAX indication; replenish water if level gets lower than MIN indication.

INSTRUCTIONS FOR USE

■ Instructions for key of remote controller

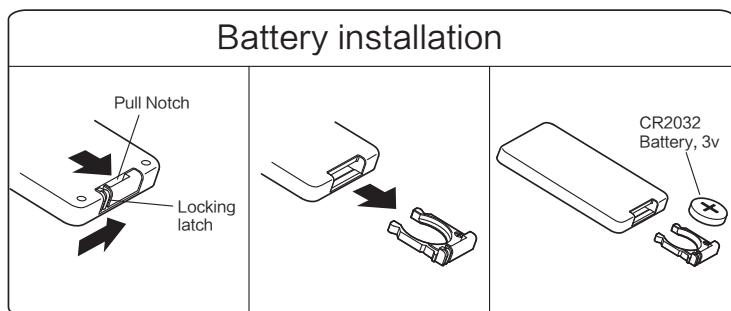
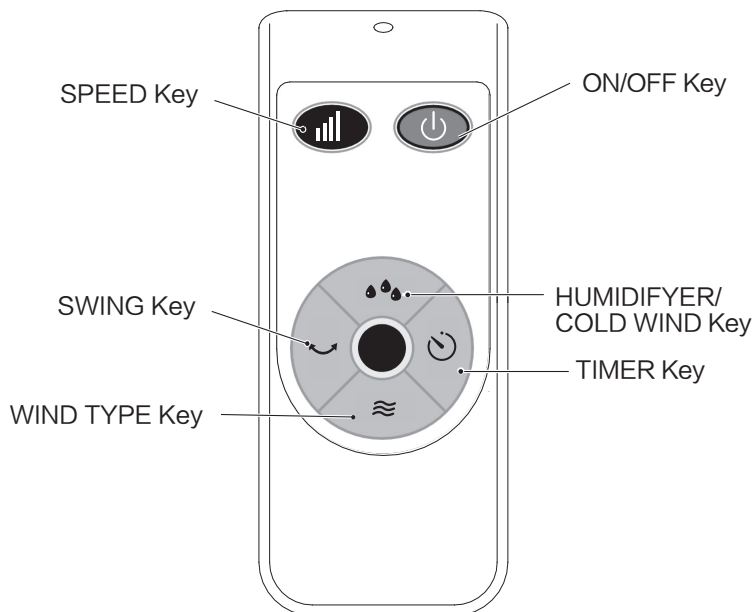

It uses one button battery of type "CR2032".

Warm tips:

1. The positive pole shall be faced upward when installing the battery.
2. The remote controller shall be in 5m in the front of the product, and normally used in the range of deviation angle for 30 degrees.

MAINTENANCE INSTRUCTION

The fan requires little maintenance. Do not try to fix it by yourself. Refer it to qualified service personnel if service is needed.

1. Before cleaning and assembling, fan must be unplugged.
2. To ensure sufficient air supply, the honeycomb filter and dust filter shall be cleaned regularly.
3. Please wipe the exterior parts with a soft cloth soaking a mild detergent.
4. Do not use any abrasive detergent or solvents to avoid scratching the surface.
Do not use any of the following as a cleaner: gasoline, thinner.
5. Do not allow water or any other liquid into the motor housing or interior parts.

CLEANING

1. Be sure to unplug from the electrical supply source before cleaning.
2. Plastic parts should be cleaned with a soft cloth moisten with mild soap. Thoroughly remove soap film with dry cloth.

