

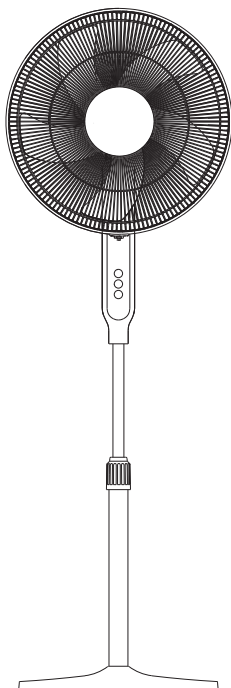

# OWNER'S MANUAL

## Inverter Cooling Fan FS40-19PRD



GD Midea Environment Appliances MFG. Co.Ltd.  
No.28,Dong Fu Road,HeSui East Industrial Area,Dong Feng Town,  
ZhongShan,GuangDong,China.

***READ AND SAVE THESE INSTRUCTIONS***

Attention: Pictures in the IM are for reference only.

## CAUTION

Read Rules for Safe Operation and Instructions Carefully.

## WARNING

1. If the supply cord is damaged, it must be replaced by manufacturer or its service agent or a similarly qualified person in order to avoid a hazard.
2. Indoor use only.
3. To protect against the risk of electrical shock, do not immerse the unit, cord or plug in water or other liquid.
4. This appliance is not intended for use by persons (including children) with reduced physical, sensory or mental capabilities, or lack of experience and knowledge, unless they have been given supervision or instruction concerning use of the appliance by a person responsible for their safety.  
Children should be supervised to ensure that they do not play with the appliance.
5. When the appliance is not in use and before cleaning, unplug the appliance from the outlet.
6. When the fan was assembled, the rotor blade guard shall not be taken off anymore.
7.  Correct Disposal of this product  
This marking indicates that this product should not be disposed with other household wastes throughout the EU. To prevent possible harm to the environment or human health from uncontrolled waste disposal, recycle it responsibly to promote the sustainable reuse of material resources. To return your used device, please use the return and collection systems or contact the retailer where the product was purchased. They can take this product for environmental safe recycling.

## RULES FOR SAFE OPERATION

1. Never insert fingers, pencils, or any other object through the grille when fan is running.
2. Disconnect fan when moving from one location to another.
3. Be sure fan is on a stable surface when operating to avoid overturning.
4. DO NOT use fan in window, rain may create electrical hazard.
5. Household use only.

# INSTALLATION INSTRUCTIONS

## ■ Name of components

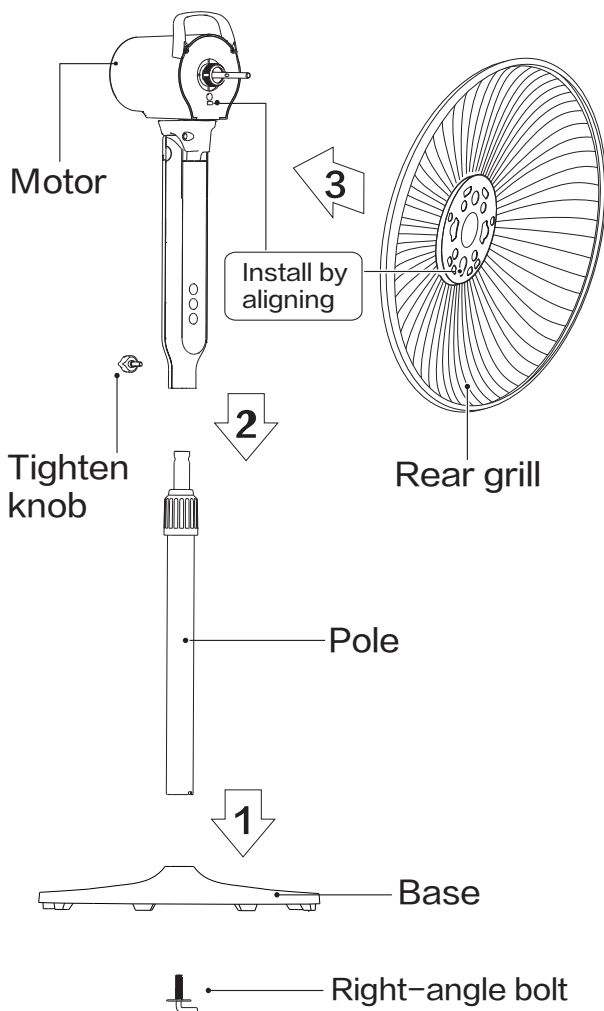

### Base Installation

Align the column with the groove on the base and fix them together using a right-angle bolt.

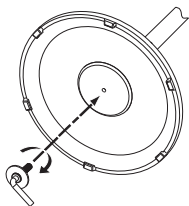

**Considerate Hint:**  
Remove parts from the component before performing installation.

## Front and Rear Guard Installation

Align Catch of the Front Guard with the illustrated position of the Rear Guard.

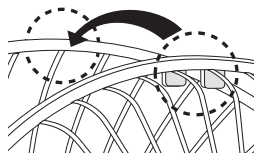

Press guards sequentially with both hands.

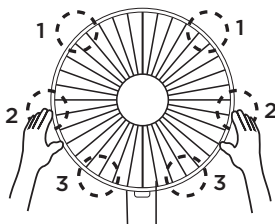

Self-Catch Installation.

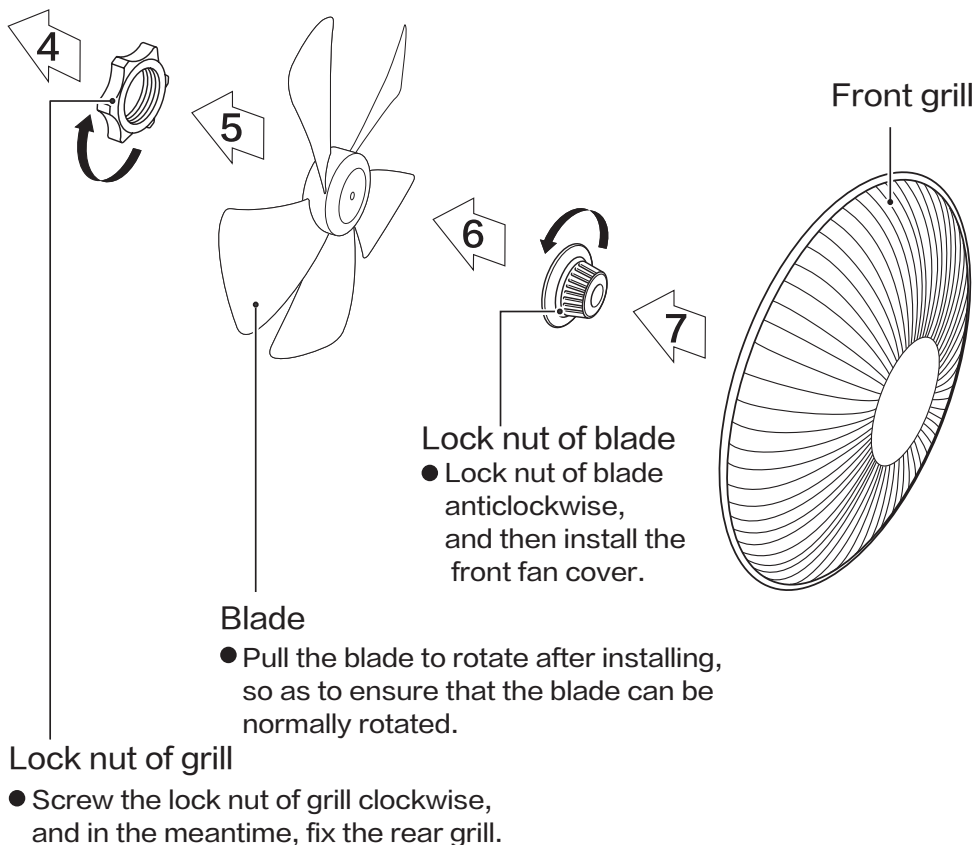
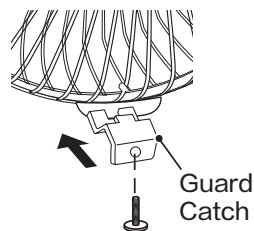

# INSTRUCTIONS FOR USE

## ■ Instructions for key of remote controller

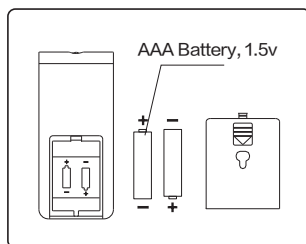
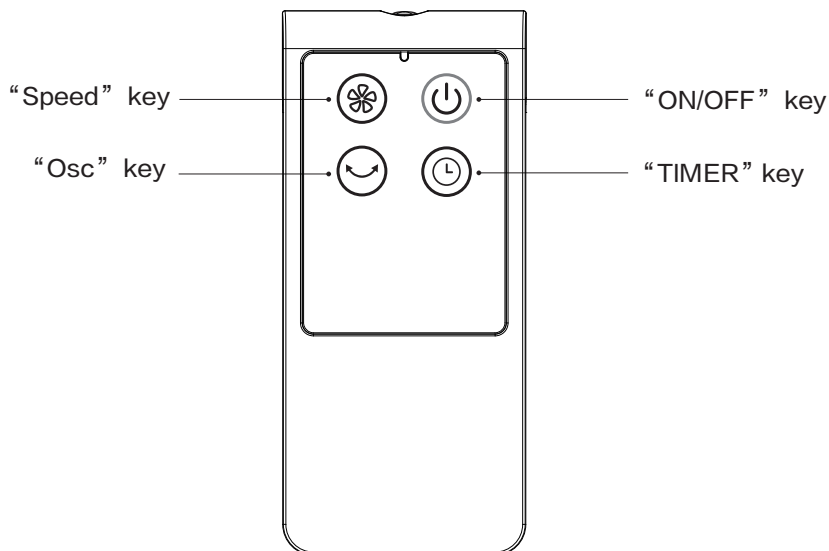

Considerate Hint:

Effective Range of Remote Control: within 5 m distance and 30-degree deflection in front of Product.

Use manganese or alkaline batteries of type "AAA". Do not use rechargeable batteries.

# INSTRUCTIONS FOR USE

## ■ Instructions for operation of body

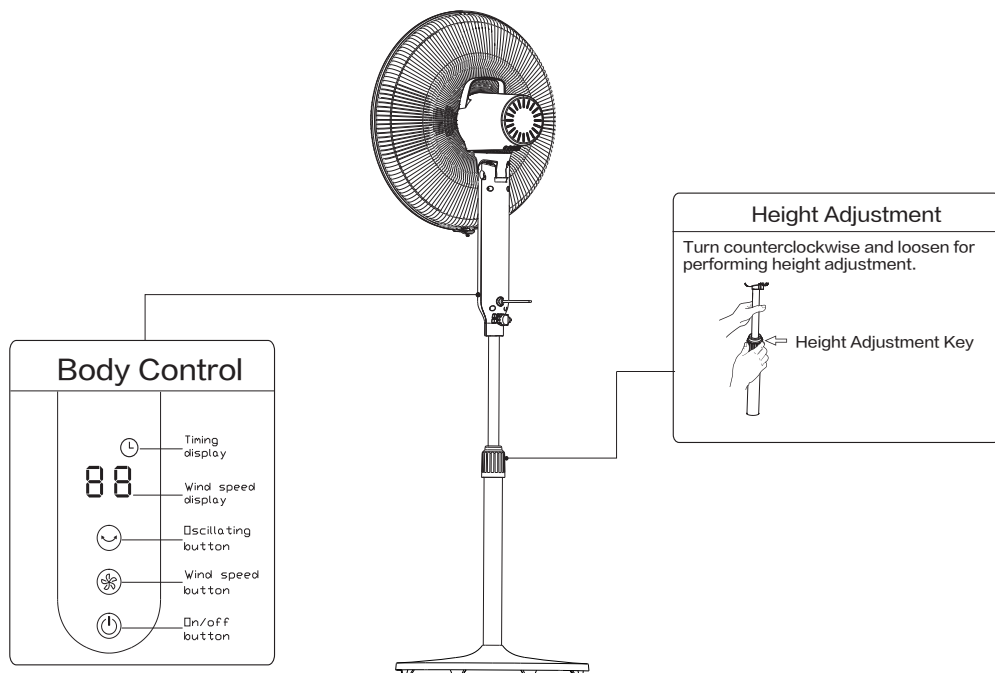

## **MAINTENANCE INSTRUCTION**

The fan requires little maintenance. Do not try to fix it by yourself. Refer it to qualified service personnel if service is needed.

1. Before cleaning and assembling, fan must be unplugged.
2. To ensure adequate air circulation to the motor, keep vents at the rear of the motor free of dust. Do not disassemble the fan to remove dust.
3. Please wipe the exterior parts with a soft cloth soaking a mild detergent.
4. Do not use any abrasive detergent or solvents to avoid scratching the surface.  
Do not use any of the following as a cleaner: gasoline, thinner.
5. Do not allow water or any other liquid into the motor housing or interior parts.

## **CLEANING**

1. Be sure to unplug from the electrical supply source before cleaning.
2. Plastic parts should be cleaned with a soft cloth moisten with mild soap.  
Thoroughly remove soap film with dry cloth.



# 美的电风扇

使用说明书

FS40-19PRD

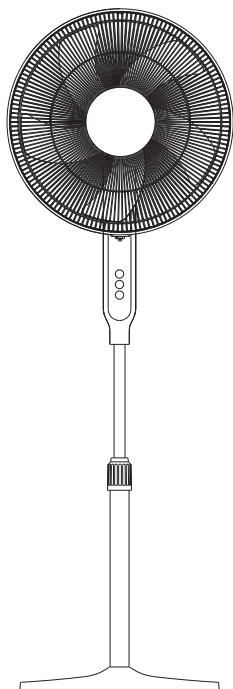

此图纸不作印刷，仅用于产品使用说明。说明书中图片仅为示意图，若有变动，请以实物为准！



# 安 装 说 明

## ■ 各部件名称

请按顺序安装

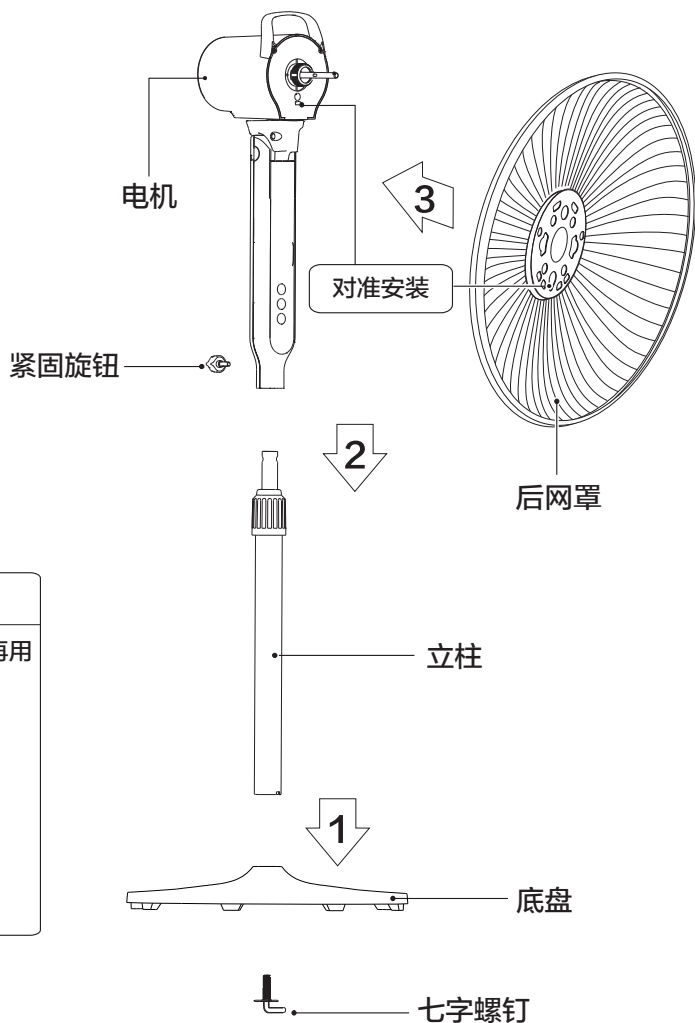

### 底盘安装

将立柱和底盘的卡位对准,再用7字螺栓来固定。

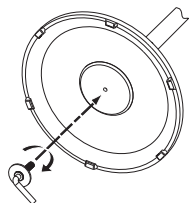

### 温馨提示:

安装前,先将零件从部件上旋出,再进行安装。

## 前后网罩安装

前网罩卡扣对准后网罩的图示位置。

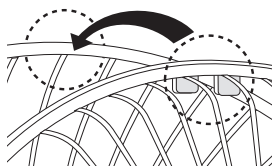

双手按顺序按压网罩。

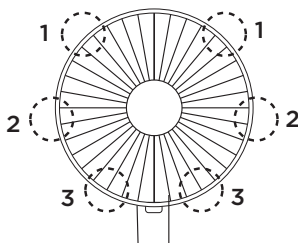

自扣式安装。

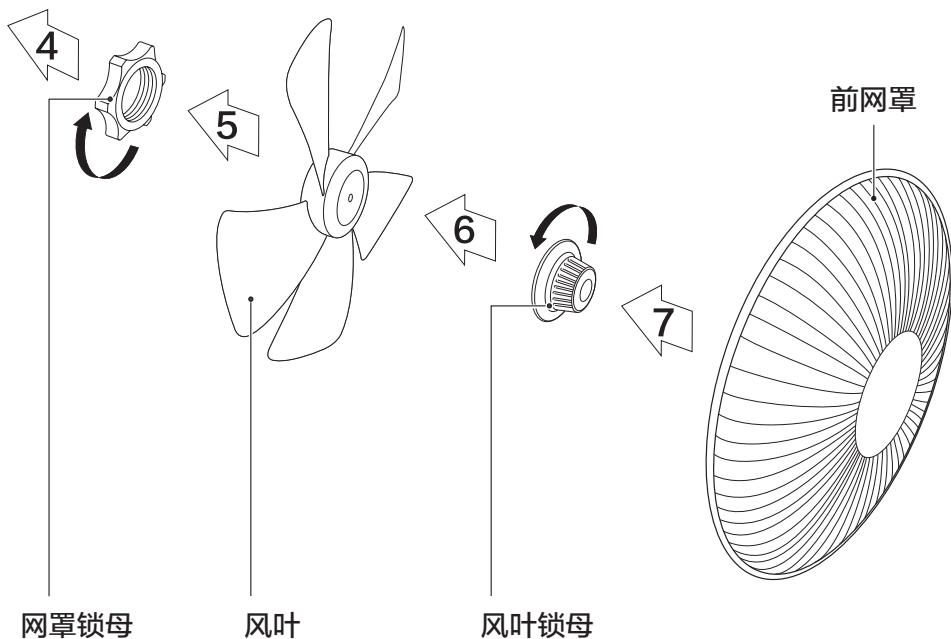
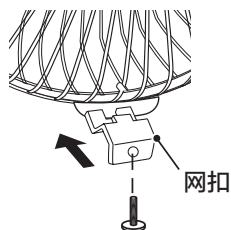

● 顺时针旋紧网罩锁母，同时固定后网罩。

● 安装风叶后，用手拨动风叶旋转，确保风叶能正常转动。

● 逆时针旋紧风叶锁母，然后安装前网罩。

# 使用 说明

## ■ 遥控器按键说明

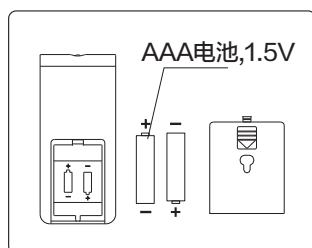
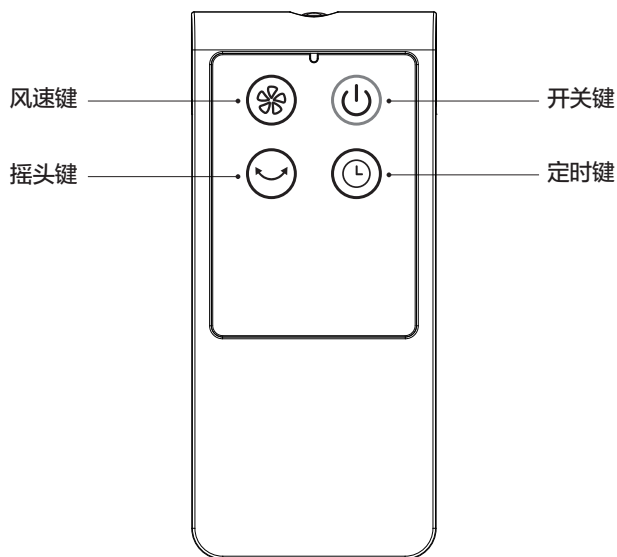

### 温馨提示:

遥控器在产品正面5米内, 偏离角度在30度范围内正常使用。

请使用型号为"AAA"的锰电池或碱性电池, 不要使用不可回收电池。

## ■ 机身操作说明

